



CAT115 Curved Line Array



APPLICATIONS

Performing Arts Centers
Cruise Ships
House of Worship
Theaters / Auditoriums

FEATURES

Curved Array Technology
Max Output 133 dB SPL**
LF Device: (1) 15 in. (380mm)
HF Devices: (2)
Exit: 1.4 in. (35.6mm)
Voice Coil Diam: 3.0 in. (76.2mm)
100° H x 25° V Coverage
Two-Way Active
Black or Custom Finishes
Terminal Strip Connector

** [Single cabinet, Peak]

GENERAL DESCRIPTION

The CAT™ 115 system is an innovative design that has all of the advantages of a traditional line array which includes minimal lobing and cancellation but uses fewer speaker modules.

Each waveguide module (single cabinet) provides 100° of horizontal coverage and 25° of vertical coverage. When vertically flown, the three CAT™ waveguide modules (3 cabinets) create a seamless 75° vertical by 100° horizontal coverage pattern.

The CAT™ system uses three cabinets to achieve a larger coverage area compared to traditional line arrays. Traditional line arrays require more than three cabinets to achieve the same coverage equal to the CAT™ system. Additionally, many line arrays lack adequate horizontal and vertical coverage, thus requiring additional "fill" cabinets to achieve the desired coverage.

The patented CAT™ rigging system fuses each speaker cabinet together to create a seamless cosmetically appealing vertical array.

Clair Brothers combines amplification, and proprietary DSP processing in a portable rack system. Custom cabling is available and can be pre-wired for specific installation requirements.

As with all Clair Brothers products, the cabinet is constructed of the finest Baltic birch and finished with a rugged exterior epoxy.

OPTIONS & ACCESSORIES

Full Cluster Transport Dolly / Installation Cradle for (3x) CAT™ Array
CS18-II Subwoofer Package
Custom Rigging
Custom Grille and Exterior Color Choices

CAT115 Curved Line Array



AUDIO SPECIFICATIONS

Loudspeaker Type	Two-Way Active	
Frequency Response (+/- 2dB)	39Hz–20kHz	
Recommended Power Amplifier	1200–2400W @ 8 Ohms	
Sensitivity (1 Watt @ 1 Meter)	LF	98.5 dB SPL
	HF	100 dB SPL
Maximum Output	Cont.	131 dB SPL*
	Peak	133 dB SPL**
Drivers	LF	(1) 15 in. (380.0mm)
	HF	(2) Exit 1.4 in. (35.6mm), Voice coil diameter 3.0 in. (76.2mm)
Nominal Impedance	LF	8 Ohms
	HF	8 Ohms
Power Handling	LF	1200W Cont.
	HF	320W Cont.
Dispersion	Single Cabinet	100° H x 25° V
	Three Cabinet Array	100° H x 75° V
Input Connection	(1) 4-Position Terminal Strip	

MECHANICAL SPECIFICATIONS

Enclosure	Shell	18mm, 13-Ply Baltic Birch
	Finish	Black Epoxy Mastic
Grille	Fabric and Perforated Steel	
Dimensions	Front Height	16.91 in. (429.6mm)
	Rear Height	6.00 in. (152.4mm)
	Width	32.57 in. (827.2mm)
	Depth	25.62 in. (650.9mm)
Weight	102 lbs. (46.3kg)	
Shipping Weight	117 lbs. (53.1kg)	

Audio specifications are for a three (3) cabinet array, unless noted otherwise.

* Maximum output Cont. for single cabinet.

Note: All wattage figures are calculated using the rated nominal impedance.

** Maximum output Peak for single cabinet.

Clair Brothers products are designed to perform optimally by utilizing factory recommended proprietary DSP settings.

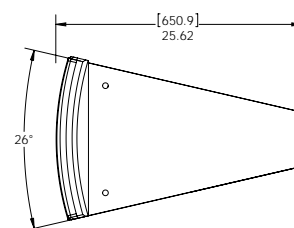
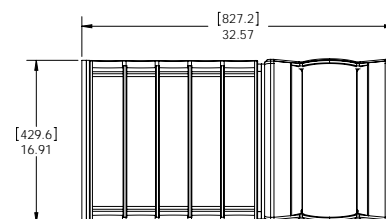
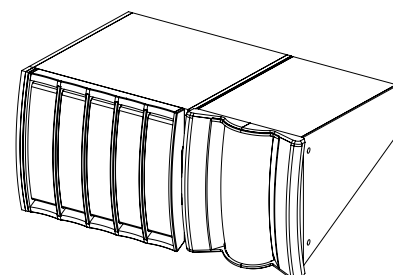

CAT114 Terminal Strip Configuration

LEFT TO RIGHT	USE
Black	Low (-)
Red	Low (+)
Black	High (-)
White	High (+)

ARCHITECT AND ENGINEERS SPECIFICATIONS

The loudspeaker shall be a two-way active system featuring a total of three drivers. The low frequency section shall contain one 15" driver, capable of handling 1200 watts of pink noise with a 6 dB crest factor for 8 hours (as per EIA RS-426-A standard). The high frequency section shall contain (2) 1.4" exit / 3" voice coil diameter compression drivers and shall be attached to a 100°H x 25°V constant-directivity horn. The drivers shall be capable of handling 160 watts (1 kHz–10 kHz) of pink noise with a 6 dB crest factor for 2 hours (as per AES-1984 and ANSI S4.26-1984 standards). The crossover frequency shall be 2 kHz. The enclosure shall be constructed of 18mm, 13-ply Baltic birch and be covered with black epoxy mastic. The cabinet shall feature notched aluminum corners. Dimensions shall be 16.91" high (front), 6.00" high (rear), 32.57" wide and 25.62" deep. The cabinet weight shall be 102 lbs. (46.3kg). The loudspeaker system shall be the Clair Brothers CAT™ 115 system.

CLAIR BROTHERS • ONE CLAIR BOULEVARD • MANHEIM, PA 17545 • 717-665-4000 • WWW.CLAIRBROTHERS.COM

CBAS20140827

Due to constant research, development and improvements all specifications are subject to change without notice.

